

SURVEY PLAT

JIMMY W. POGUE, INC.

This is to certify that I have, this date, made a careful and accurate survey on the ground of property located at
 No. 4651 ELSBY AVENUE in the city of DALLAS Texas
 Lot No. 13 Block No. B City Block No. 5680, Texas
 of LINWOOD PLACE ADDITION, an addition to the
 City of DALLAS, DALLAS COUNTY, Texas, according to the MAP thereof
 recorded in Volume 3 Page 429 MAP Records MAP DALLAS County, Texas.

NOTE: PER THE NATIONAL
 FLOOD INSURANCE PROGRAM
 COMMUNITY PANEL NO.
 48113C0330 J, THIS
 LOT IS IN ZONE X. AREAS
 DETERMINED TO BE OUT-
 SIDE THE 12
 500 YEAR FLOOD
 PLAIN.

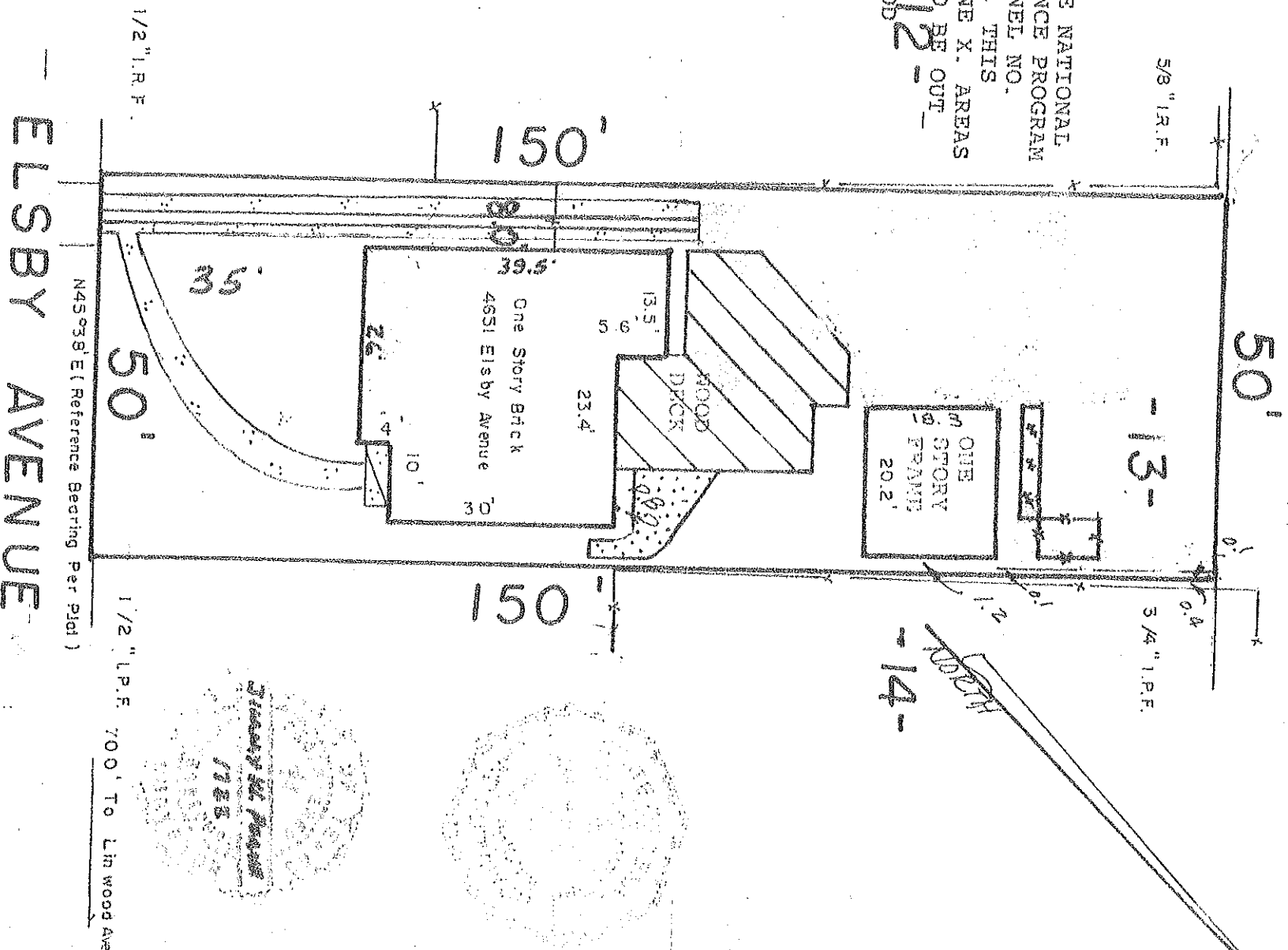

The plat hereon is a true representation of the property, as determined by on the ground survey, the lines and dimensions of said property being as indicated by the plat; the size, location and type of buildings and improvements are as shown, all improvements being within the boundaries of the property, set back from property lines the distance indicated, and that the distances from the nearest intersecting street, or road, is as shown on said plat, all corner monuments are as shown.
THERE ARE NO ENCROACHMENTS OR PROTRUSIONS, EXCEPT AS SHOWN.

Jimmy W. Pogue
 REGISTERED PROFESSIONAL
 LAND SURVEYOR NO. 1722

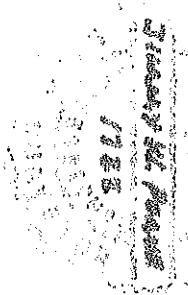

Scale 1" = 20'
 Date 1-11-02
 Job No. 64083

This survey was performed in connection with the transaction described in G.F. No. 0203108V of COMMERCIAL ACCTH
 Title Company. Use of this survey for any other purpose or by any other parties shall be strictly prohibited as this survey is a copyright owned by Jimmy W. Pogue, Inc., and all other uses are forbidden without prior written consent of Jimmy W. Pogue, Inc.

JIMMY W. POGUE, INC.
 3510 MARVIN D. LOVE FREEWAY
 DALLAS, TEXAS 75224
 PHONE (214) 371-0666